

# THE LODGE AT SEA ISLAND

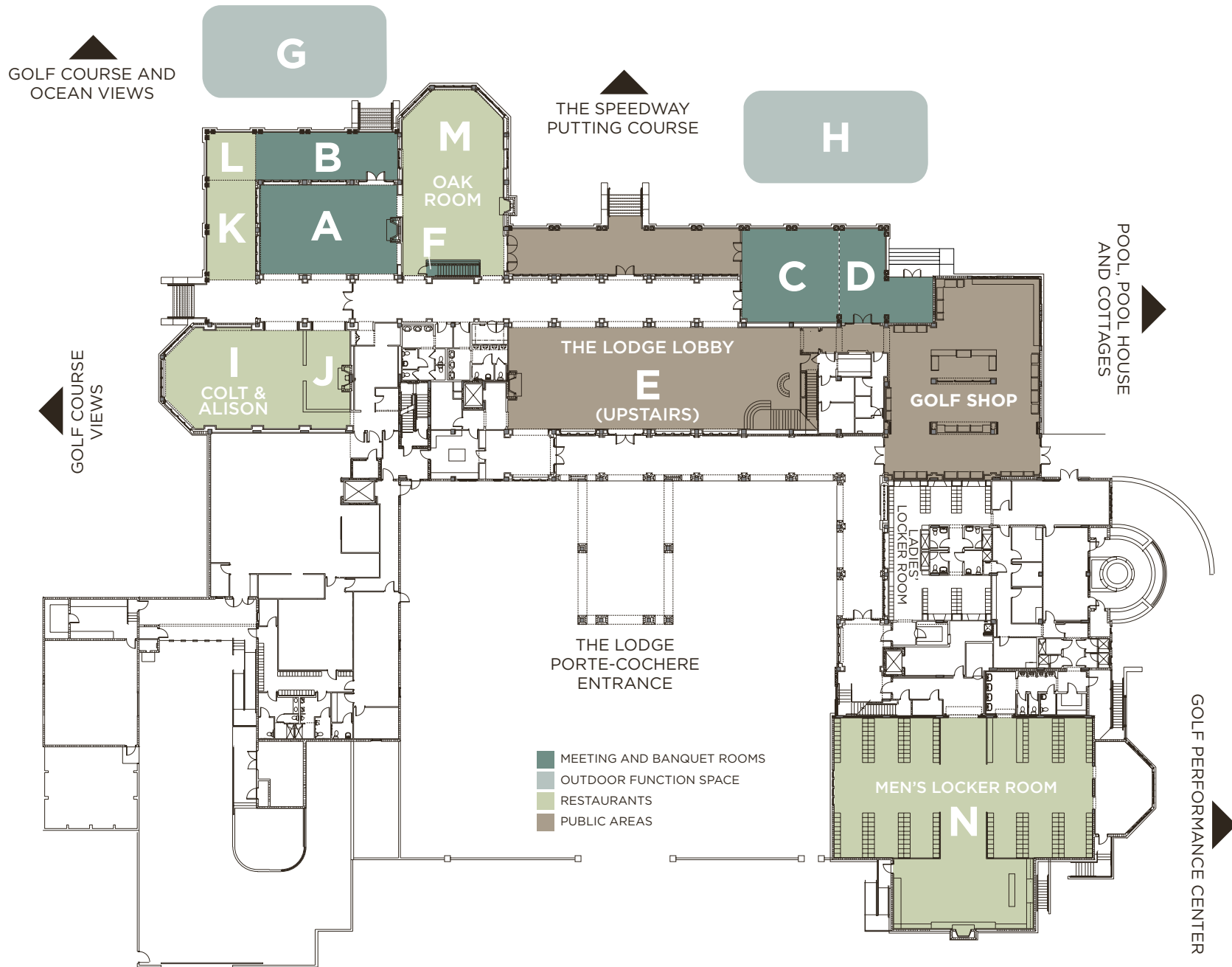

<i>Location</i>	<i>Conference</i>	<i>U-Shape</i>	<i>Hollow</i>	<i>Classroom</i>	<i>Theater</i>	<i>Reception</i>	<i>Banquet</i>	<i>Dimensions</i>	<i>Sq. Ft.</i>	<i>Ceiling Ht.</i>
<b>Meeting and Banquet Rooms</b>										
A Terrace Room	30	34	40	84	140	100	90	48' x 30'	1,440	13'
B Terrace Room Veranda	-	-	-	-	-	-	-	44' x 15'	660	11'
C Trophy Room I	24	18	28	40	115	80	64	30' x 30'	900	12'
D Trophy Room II	18	15	18	20	42	50	30	15' x 30'	450	10'
Trophy Room (I & II)	30	26	32	60	156	130	72	45' x 30'	1,350	-
E Parlor	14	-	-	-	30	25	-	15' x 20'	300	9'
F Lodge Wine Cellar	20	Permanent Dining Table				30	20	32' x 13'	416	10'
Pool House	-	-	-	-	-	-	40	22' x 39'	835	15'
<b>Outdoor Function Space</b>										
G Terrace Room Lawn	-	-	-	-	-	200	-	-	5,760	-
H Trophy Room Lawn	-	-	-	-	-	130	-	-	1,800	-
Pool House Patio and Lawn	-	-	-	-	-	100	-	-	1,800	-
<b>Restaurants</b>										
I Colt & Alison Main Dining Room	-	-	-	-	-	-	-	35' x 47'	1,645	13'
J Colt & Alison Semi-Private Dining Room	-	-	-	-	-	-	-	12' x 16'	192	13'
K Colt & Alison Veranda	-	-	-	-	-	-	-	11' x 31'	341	11'
L Colt & Alison Private Dining Room	-	-	-	-	-	-	-	15' x 16'	240	9'
M Oak Room	-	-	-	-	-	90	60	35' x 50'	1,750	13'
N Men's Locker Room	-	-	-	-	-	120	50	51' x 80'	4,080	10'

