

THE CLOISTER AT SEA ISLAND

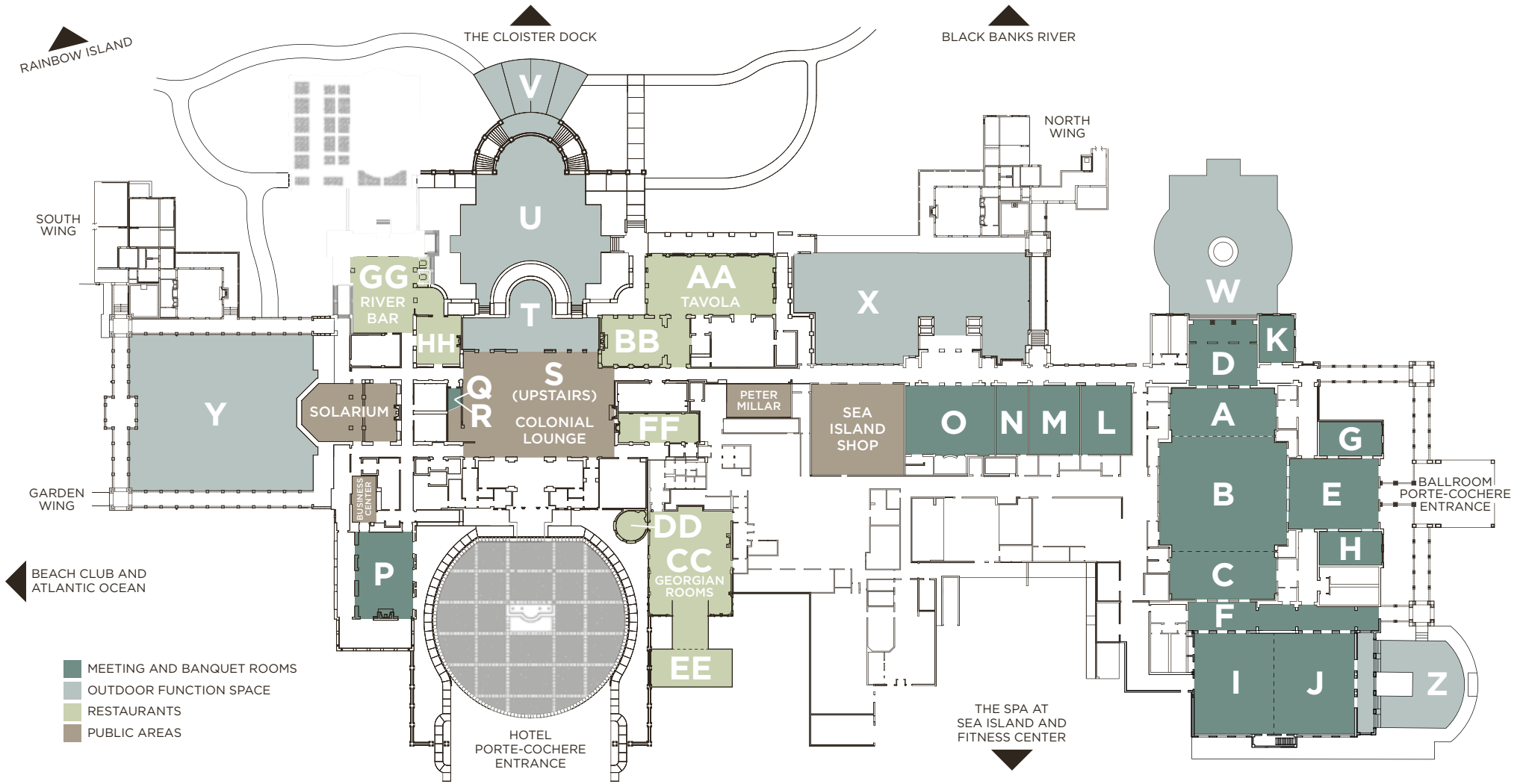

<i>Location</i>		<i>Conference</i>	<i>U-Shape</i>	<i>Hollow</i>	<i>Classroom</i>	<i>Theater</i>	<i>Reception</i>	<i>Banquet</i>	<i>Dimensions</i>	<i>Sq. Ft.</i>	<i>Ceiling Ht.</i>
Meeting and Banquet Rooms											
A	Cloister Ballroom I	50	44	54	90	105	100	100	60' x 27'	1,620	18'
B	Cloister Ballroom II	64	72	84	210	300	300	300	72' x 63'	4,536	21'
C	Cloister Ballroom III	50	44	54	90	105	100	100	60' x 27'	1,620	18'
	Cloister Ballroom (I, II, & III)	106	114	120	405	600	500	500	-	7,855	-
D	Cloister Foyer I	-	-	-	-	-	80	-	38' x 34'	912	13'
E	Cloister Foyer II	-	-	-	-	-	240	-	50' x 55'	2,750	13'
F	Cloister Foyer III	-	-	-	-	-	80	-	102' x 14'	1,428	13'
G	Sapelo	26	20	24	30	44	44	30	19' x 34'	646	11'
H	Cumberland	26	20	24	30	44	44	30	19' x 34'	646	11'
I	Mizner Ballroom I	32	40	52	132	250	140	130	44' x 57'	2,508	18'
J	Mizner Ballroom II	32	40	52	132	250	140	130	44' x 57'	2,508	18'
	Mizner Ballroom (I & II)	56	52	72	192	500	280	260	89' x 57'	5,073	18'
K	Ossabaw	20	16	20	24	30	30	24	19' x 27'	513	11'
L	Oglethorpe Room	24	32	36	60	76	76	60	28' x 38'	1,064	12'
M	Sea Island Summit Room	20	Permanent Boardroom Table				50	20	28' x 38'	1,064	12'
N	Hudson Boardroom	15	Permanent Boardroom Table				-	15	17' x 30'	510	11'
O	Clubroom	30	40	46	84	200	150	120	50' x 38'	1,900	17'
P	Spanish Lounge	28	21	36	72	138	140	80	48' x 32'	1,536	18'
Q	Cloister Wine Cellar	20	Permanent Boardroom Table				30	18	13' x 18'	576	8'
R	St. Catherines	14	-	-	16	24	-	10	23' x 14'	322	8'
S	Black Banks Parlor	18	22	26	32	40	40	32	38' x 26'	988	8'
Outdoor Function Space											
T	Upper Black Banks Terrace (Covered)	-	-	-	-	100	80	-	1,800	-	-
U	Black Banks Terrace	-	-	-	-	-	300	240	-	4,500	-
V	Lower Black Banks Terrace	-	-	-	-	-	100	80	-	2,500	-
W	Cloister Patio	-	-	-	-	-	120	90	-	1,650	-
X	North Patio	-	-	-	-	-	100	60	-	1,250	-
Y	Cloister Garden	-	-	-	-	-	200	100	-	2,250	-
Z	Mizner Courtyard	-	-	-	-	-	120	60	-	2,500	-
	Rainbow Island	-	-	-	-	-	500	500	-	10,000	-
	Explorer at The Cloister Dock	-	-	-	-	49	-	-	-	-	-
Restaurants											
AA	Tavola	-	-	-	-	-	200	150	32' x 70'	2,240	11'
BB	Tavola Bar	-	-	-	-	-	70	40	26' x 34'	884	12'
CC	Georgian Rooms Main Dining Rooms	-	-	-	-	-	-	90	-	2,640	16'
DD	Georgian Rooms Private Dining Room	-	-	-	-	-	-	10	17' Ø	213	14'
EE	Georgian Rooms Orangery	-	-	-	-	-	-	46	46' x 24'	1,104	24'
FF	Georgian Rooms Lounge	-	-	-	-	-	-	36	16' x 44'	704	12'
GG	River Bar	-	-	-	-	-	120	64	34' x 43'	1,462	12'
HH	River Bar Lounge	-	-	-	-	-	25	-	25' x 25'	625	12'